

# 29F0318-1SR-10



## PHYSICAL DIMENSIONS:

A	4.83 [.190]	+ 0.08 [.003]
B	4.50 [.177]	+ 0.08 [.003] - 0.10 [.004]
B1	7.04 [.277]	+ MAX
C	4.19 [.165]	+ 0.10 [.004]
C1	4.83 [.190]	+ MAX
D	2.24 [.088]	+ 0.08 [.003]
E	1.27 [.050]	+ 0.13 [.005]

## WIRE DIMENSIONS:

T1	2.16 [.085]	+ 0.25 [.010]
T2	0.50 [.020]	+ TYP.
T3	0.25 [.010]	+ TYP.

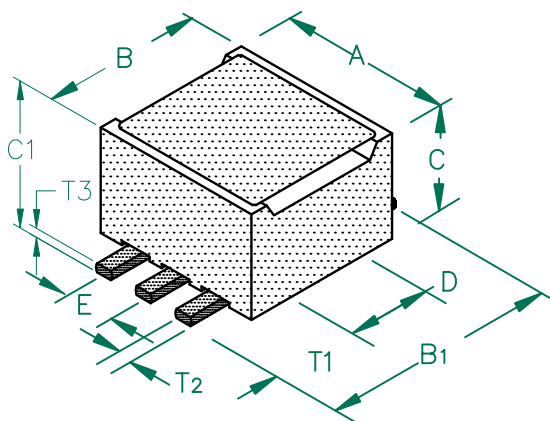

**UNCONTROLLED DOCUMENT**

## ELECTRICAL CHARACTERISTICS:

Z @ 100MHz ( $\Omega$ )	DCR ( $\Omega$ )	Rated Current
Nominal	119	
Minimum	90	
Maximum	149	6000 mA

NOTES: UNLESS OTHERWISE SPECIFIED

1. TAPED AND REELED per CURRENT EIA SPECIFICATIONS 13" REELS, 900 PCS/REEL.
2. COMPONENTS SHOULD BE ADEQUATELY PREHEATED BEFORE SOLDERING.
3. REF. CARRIER TAPE SPECIFICATION # CART318-13.
4. TERMINATION FINISH IS 100% TIN.

|Z|, R, AND X vs. FREQUENCY

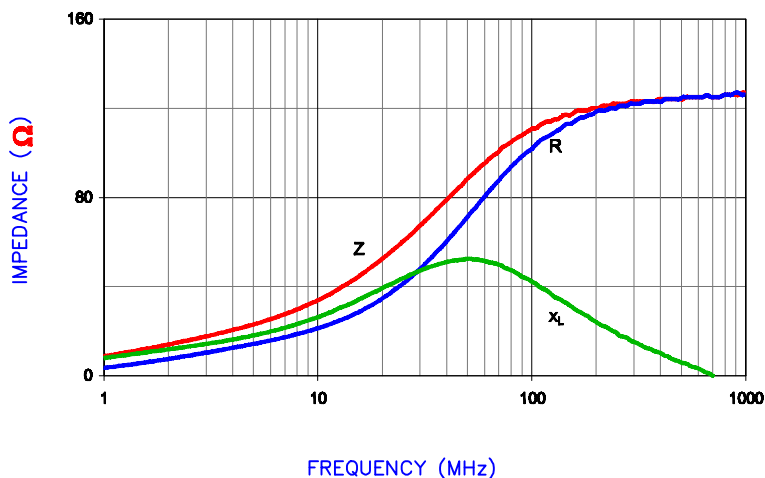

LAND PATTERNS FOR REFLOW SOLDERING

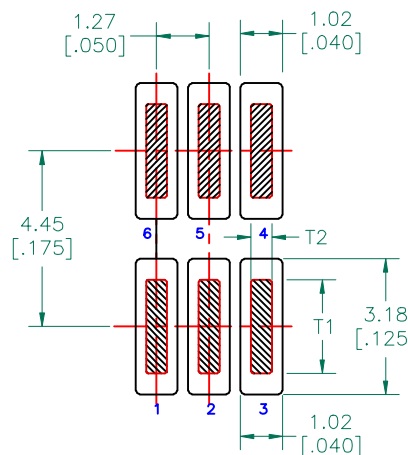

RECOMMENDED SOLDERING CONDITIONS

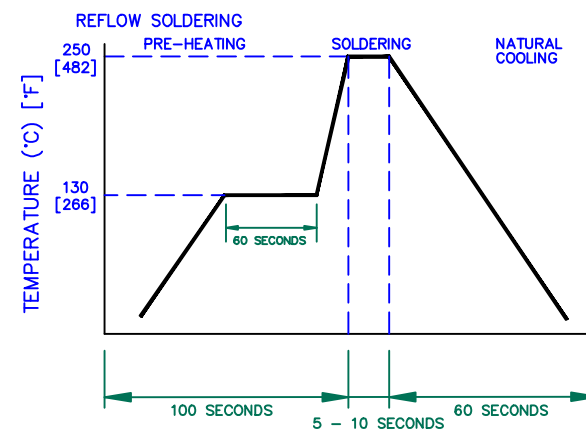

DIMENSIONS ARE IN mm (INCHES).				This print is the property of Laird Tech. and is loaned in confidence subject to return upon request and with the understanding that no copies shall be made without the written consent of Laird Tech. All rights to design or invention are reserved.			
D	UPDATE COMPANY LOGO	10/20/08	JRK	PROJECT/PART NUMBER: <b>29F0318-1SR-10</b>	REV	PART TYPE:	DRAWN BY:
C	UPDATE COMPANY LOGO	04/24/07	JRK		D	ASSEMBLY	JRK
B	CHANGE TOLS ON E DIMS ADD ROHS	03/19/07	JRK		DATE:	SCALE:	SHEET:
A	ORIGINAL DRAFT	04/30/04	JRK	04/30/04	NTS		
REV	DESCRIPTION	DATE	INT	CAD #	TOOL #		
				29F0318-1SR-10-D-2	-		

